

SECTION A-A

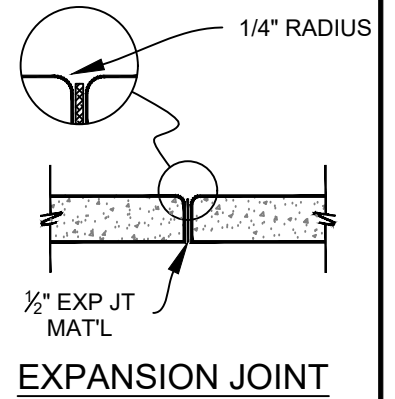

NOTES:

1. ALL CONCRETE SHALL BE CLASS 3300 - 3/4", 4-6% ENTRAINED AIR.
2. PROVIDE CONTRACTION JOINTS AT MAX 10' CENTERS.
3. SEE PROJECT PLANS FOR ELEVATIONS.
4. SEE PROJECT PLANS FOR CURB RAMP LOCATIONS.

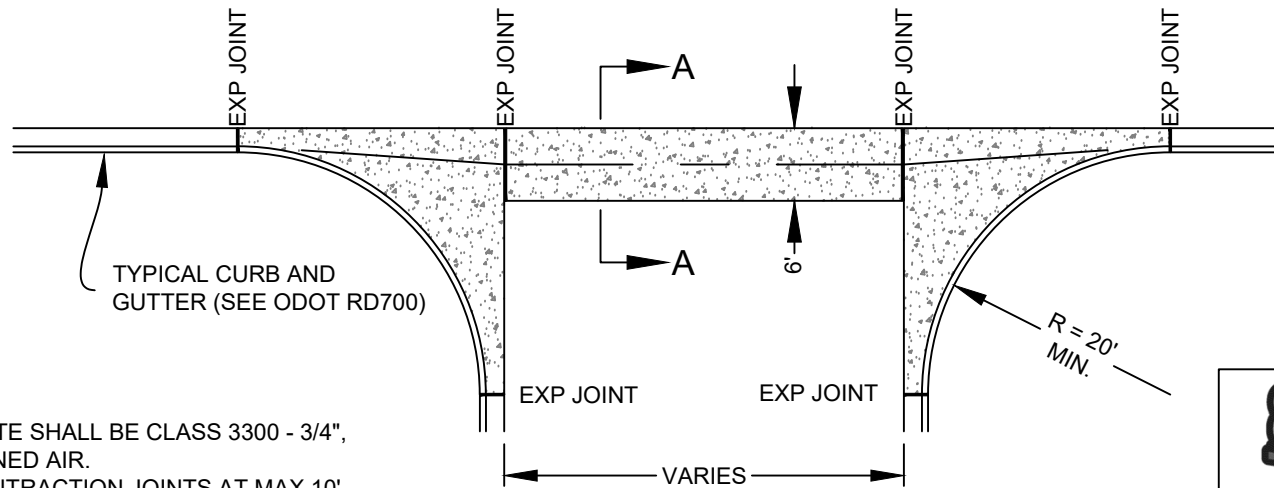
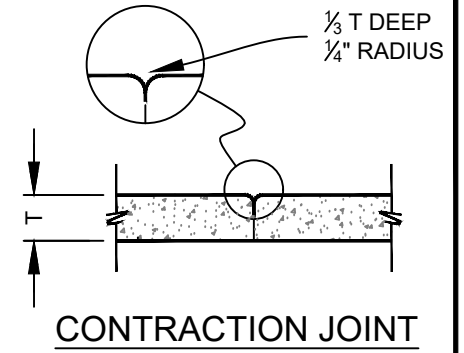
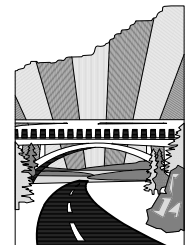

JACKSON COUNTY
Roads

JACKSON COUNTY ROADS

JAMES PHILP, P.E.
COUNTY ENGINEER

Date	By	Revision

JCRD308:
VALLEY GUTTER

H:\Engineering\LIBRARY\COUNTY\STD_DWG\CURRENT\RD300-Drainage\JCRD308-ValleyGutter.dwg

MAR. 2023

NO SCALE